

# Ditec DAB105



Ditec DAB105 ensures access without barriers and ease of operation

## Performance

Powerful and compact operator capable of satisfying the needs of high traffic doors, and also special requirements for emergency exits and fire doors, in complete compliance with most of European regulations.

- High performance with up to 90 kg door weight and mechanic servo-assisted operator, encoder controlled
- Reliable operator: strong components and real time self monitoring of the operator status
- Safety guaranteed by technological features, SOS alert system when opening, motion detection safety signal
- Very low noise level
- Many additional advanced features make Ditec DAB105 a best in class product.

## Convenient & flexible

Modern buildings require applications that are flexible and adaptable to any need: Ditec DAB105 meets these requirements.

- Easy to install, to set, and to maintain: available PUSH or PULL configurations
- Easy program selection to expand functions (with a card) if necessary
- One operator matches specific installation requirements (double leaf doors, installations in presence of wind, key controlled access)
- Easy to order: 1 item alone includes operator + cover (just add arm)
- Power assisted: the entire opening operation is carried out by low, motor assisted power making it an ideal solution for users with or without disabilities.

## Safe & reliable

Safe and convenient access without barriers, in compliance with the strict requirements of public sector, also thanks to its LOW ENERGY mode.

- Several operating modes to match different demands (PUSH & GO, power assist, key impulse)
- Low Energy mode and battery kit available
- Convenient operator control via sensors, switch, program and key selectors
- Ditec DAB105 has obtained certification for use on fire doors from the SP SITAC Organisation (certificate number SC0250-14). For more details, contact our Technical Sales Office.



## Movement arms

**DAB805PSA –PSAF**  
Arm with articulated motion.



Articulated - DAB805PSA –PSAF

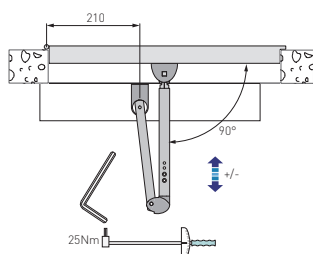

**DAB805PLAT**  
Arm with three-section articulated motion for doors that open inward; automation seen from the side.



Articulated in three sections - DAB805PLAT

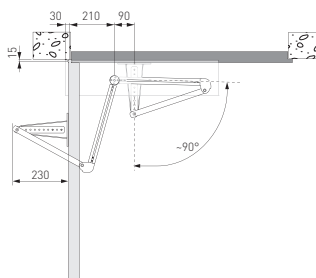

**DAB805PLA –PLAB**  
Arm with sliding motion. PLAB is for anti-panic breakout systems.



Sliding - DAB805PLA

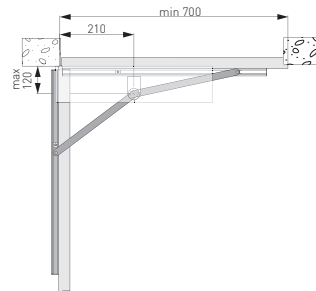

## Dimensions

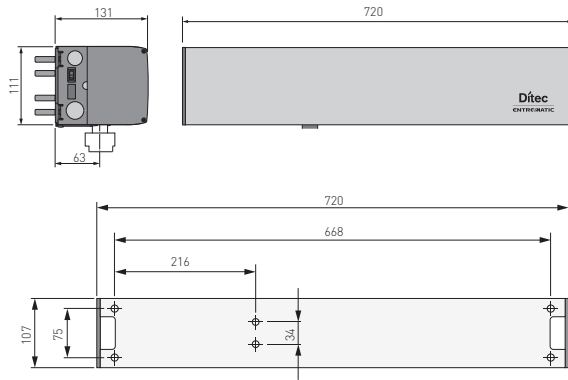

## Technical specifications

Description	Ditec DAB105
Maximum capacity	90 kg x 1.2 m
Service index	5 – heavy duty
Lifecycle	1,000,000 cycles
Power supply	120-230 V AC / 50-60 Hz
Power input	0.5 A
Opening time	3 ÷ 6 s/(0-80°) (adjustable)
Closing time	3 ÷ 6 s/(90°-10°) (adjustable)
Hold open time	1.5÷30 s
Operating temperature	-20°C / +45°C (-10°C / +50°C with batteries)
Protection level	IP 20
Product dimensions mm (H x D x L)	111x131x720
Control panel	built-in

## Operation diagram

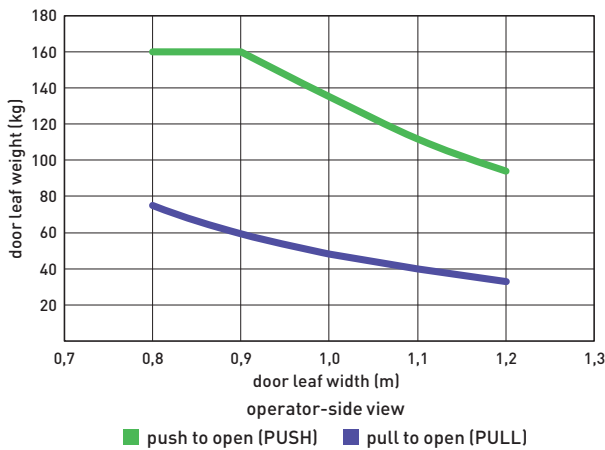

The diagram is calculated with the following formula:

$$J = 1/3 \times \text{door leaf weight} \times \text{door leaf width}^2$$

$$J = \text{inertia [kgm}^2\text{]}$$

Max. inertia: PUSH version (arm DAB805PSA) = 45 kgm<sup>2</sup>  
PULL version (arm DAB805PLA) = 16 kgm<sup>2</sup>

## Specific accessories

- DAB905BAT: battery kit
- COM400MHB: mechanical switch program selector
- COM400MKB: mechanical key program selector

## Relevant Directives and Standards

**MD**  
Machine Directive

**EMCD**  
Compatibility Directive  
Electromagnetic

**LVD**  
Low Voltage Directive

**EN 16005**  
User Safety Standard

**FIRED TESTED**  
**SP SITAC**

## Installation type

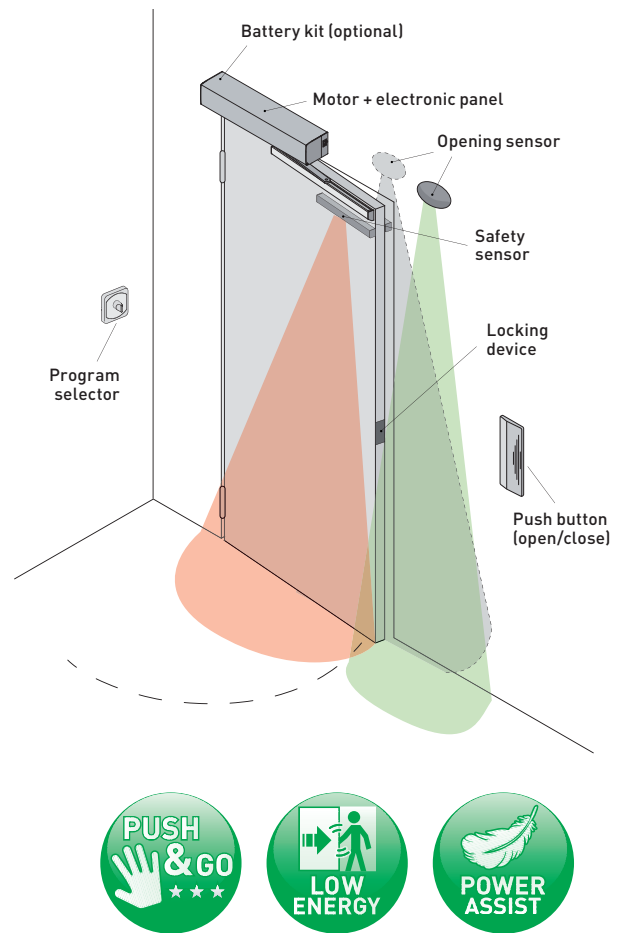

## Main components

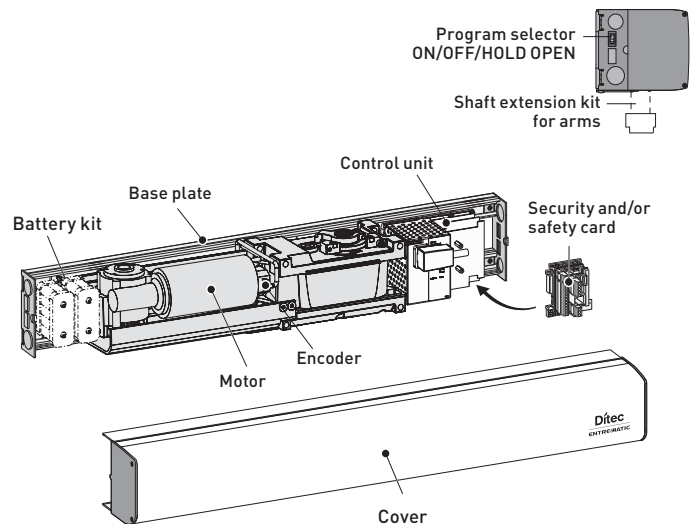

## Control accessories and sensors

The automation can be completed with Ditec command, control and safety devices.

To select appropriate items, please refer to the PM general price list.